



NW Engineers, LLC
3409 NE John Olsen Ave.
Hillsboro, OR 97124
Phone (503) 601-4401
Email: SteveW@nw-eng.com

PRELIMINARY INTERSECTION
SIGHT DISTANCE CERTIFICATION

August 28, 2020

BEAVERTON, OREGON
Department of Engineering
12725 SW Millikan Way, 4th Floor
Beaverton, Oregon 97076

Received
Planning Division
09/04/2020

Attn: Traffic Engineering

RE: 6780 SW Hall Blvd –PRELIMINARY Sight Distance Certification
DR2020-0036

The proposed access for this site is located 10 ft south of the site's north property line onto SW Hall Blvd. The speed limit along SW Hall Blvd. is 40 M.P.H., based upon the posted speed limit, requiring 400 feet of sight distance in both directions, in accordance with the City of Beaverton Engineering Design Manual Table 210.12.

As required by City of Beaverton Engineering Design Manual and the principles and methods recommended by AASHTO, sight distance from the proposed access to SW Hall Blvd. was measured to be 400 feet to the north of the access in one direction and 400 feet to the south of the access in the other direction. City of Beaverton Engineering Design Manual respectively requires that measurements be based on an eye height of 3.5 feet and an object height of 4.25 feet above the road; and be assumed to be 10 feet from the near edge of pavement to the front of a stopped vehicle, (Actual measurement is taken 15 feet from edge of travel lane).

In conclusion, I hereby certify that the intersection sight distance at the existing access for 6780 SW Hall Blvd conforms to the requirements for sight distance as set forth in the City of Beaverton Engineering Design Manual.

Steve M. White, P.E.
Project Manager

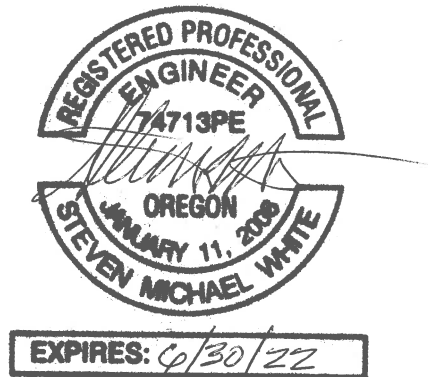

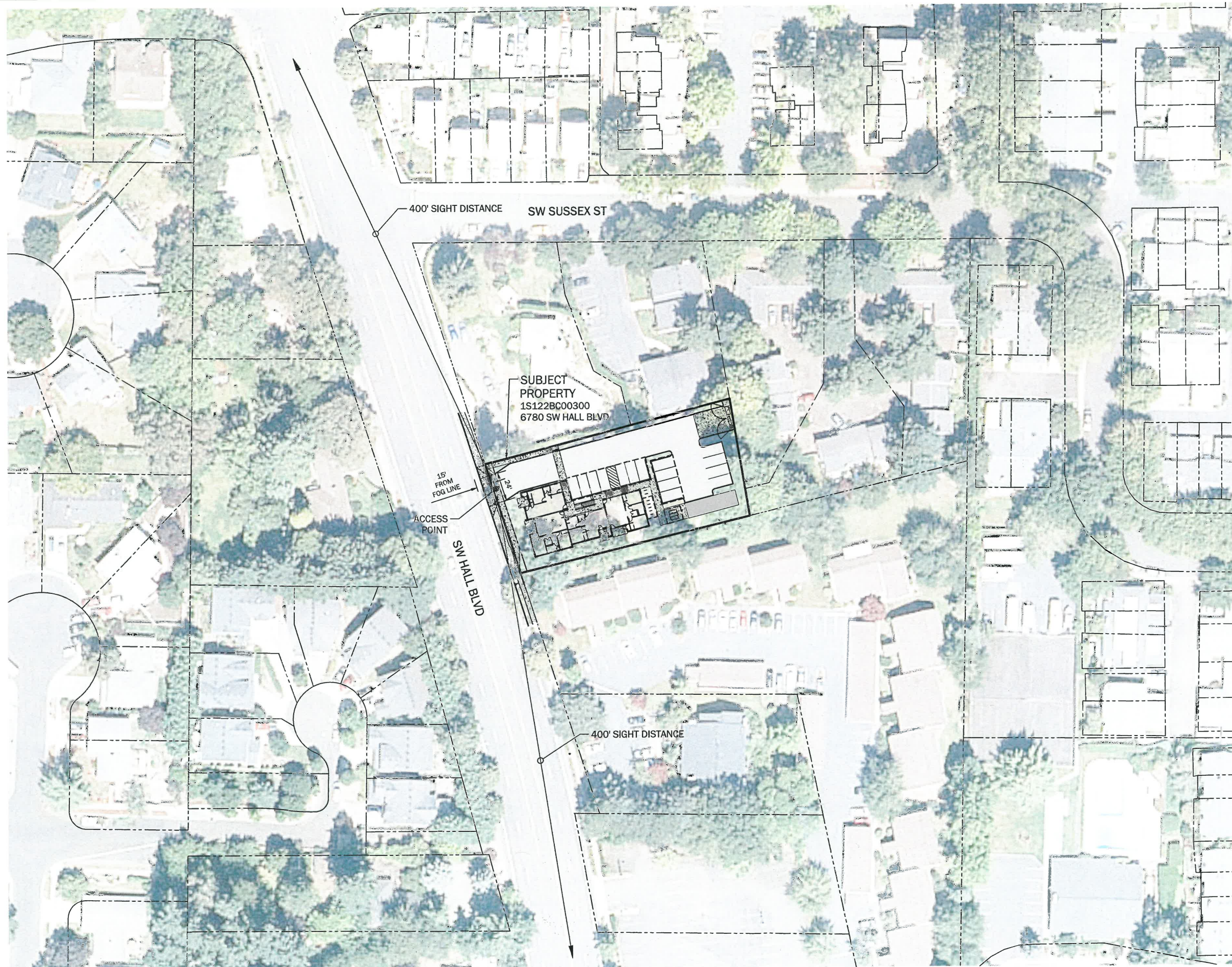

AERIAL PHOTO FROM METRO DATA RESOURCE CENTER. DATE: 2018.

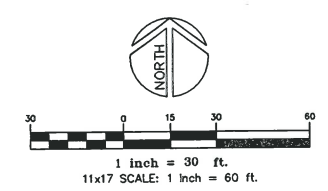

MW ENGINEERS
 Civil Engineering & Land Use Planning
 3409 NE John Oliver Avenue
 Hillsboro, OR 97124
 503.601.4402 Fax

FOR: EVERGREEN NW, LLC
 477 NE 62ND AVE.
 HILLSBORO, OR 97124
 SITE: TAX MAP 1S2 22BC
 TAX LOT 300
 BEAVERTON, OREGON

SW HALL BLVD.
 10-UNIT APARTMENT PROJECT
 NO653
 SIGHT DISTANCE EXHIBIT

REVISION	BY	DATE
1		
2		
3		
4		
5		
6		
7		

DESIGNED	DRAWN	REVIEWED	SUBMITTAL

SDIS